



PREMIER BUILDING
PRODUCTS Ltd

PBP COPING FIXING DETAIL (WITH EPDM)

GUIDE

2021

PREMIERBUILDINGPRODUCTS.CO.UK

+44 (0)1428 654781

enquiries@pbp.uk.com



PREMIER BUILDING
PRODUCTS Ltd

INSTALLATION BENEFITS

- Lightweight and easy to handle
- Simple fixing
- One-man installation
- No special tools or training required
- Mechanically fixed

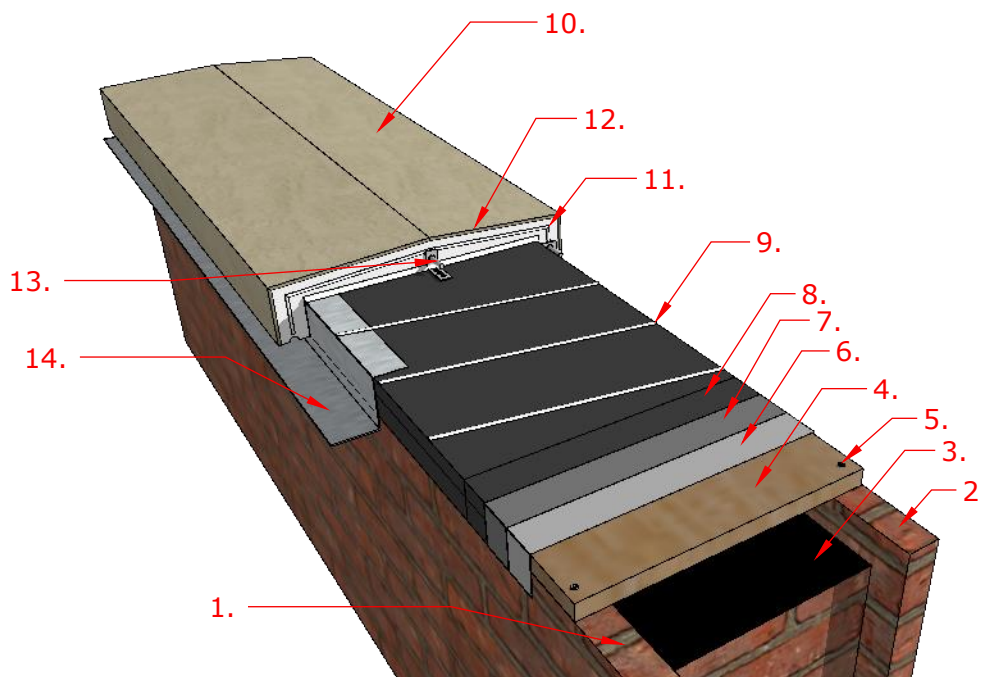

FIXING SPECIFICATIONS

1. Internal wall
2. External wall
3. Cavity
4. 18mm exterior grade plywood
5. Fixings:
 - Brick + Block - Hilti HUS-P6 Fixings, 300mm centres (minimum)
 - Timber Frame - M6x100mm wood screws, 300mm centres (minimum)
6. Primer FG-35
7. Resitrix SK-W Full Bond Self Adhesive EPDM
8. Sika Aktivator-205 to Resitrix EPDM and underside of coping
9. Sikaflex-508 adhesive in diagonal beads angled towards outside wall
 - 10mm bead at 150mm intervals covering side to side
10. Stone-Coat Coping
11. Sikaflex-508 adhesive between coping junctions to act as secondary barrier at joints
12. Silicone 825 coloured mastic with backer rod
13. Stone-Coat stainless steel bracket fixed into the 18mm plywood with a 30mm wood screw and sealed with either Sikaflex-508 adhesive or lead mate where required
14. Lead flashing (if required)
 - junction sealed between lead and Resitrix EPDM using Sikaflex-508